

		<b>Instruments and controls / 2-2</b> <b>Instrument cluster and indicator lights / 2-3</b> <b>Indicator &amp; warning lights / 2-8</b>
	<b>Instruments &amp; controls</b>	<b>2</b>
		<b>Switches / 2-14</b> <b>Auto cruise control / 2-29</b> <b>Kneeling system / 2-30</b> <b>Rear parking assist system / 2-31</b> <b>Power outlet / 2-32</b> <b>Clock / 2-32</b> <b>Thermos/refrigerator / 2-33</b> <b>Air connector / 2-33</b> <b>Steering wheel &amp; horn / 2-34</b> <b>Parking brake / 2-34</b> <b>Anti spin regulator / 2-34</b> <b>Anti-lock brake system / 2-36</b> <b>Audio remote control switch / 2-37</b> <b>Diagnostic connector / 2-37</b> <b>Auxiliary starter switch in engine room / 2-38</b> <b>Tachograph / 2-40</b> <b>Multi-display system / 2-46</b> <b>Heater and air conditioner / 2-48</b> <b>Air conditioner system / 2-49</b> <b>Front heater system / 2-53</b> <b>Heater / 2-57</b> <b>Audio system / 2-58</b>

## INSTRUMENTS AND CONTROLS

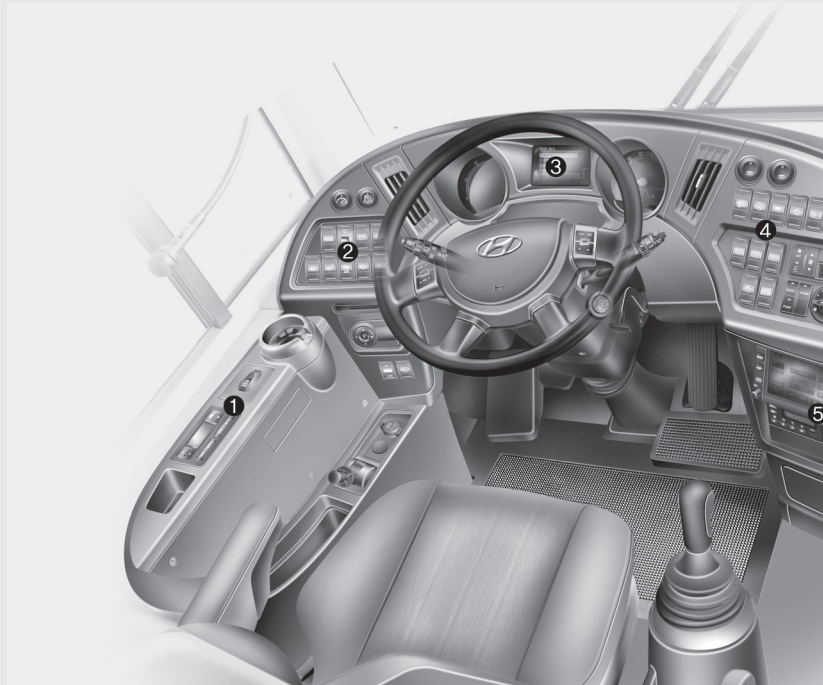

1. Air conditioner (Passenger seat) / Power window
2. System switch panel (Left)
3. Gauge panel
4. Light switch panel (Right)
5. Audio / Tachograph

OPY027200L

## INSTRUMENT CLUSTER AND INDICATOR LIGHTS

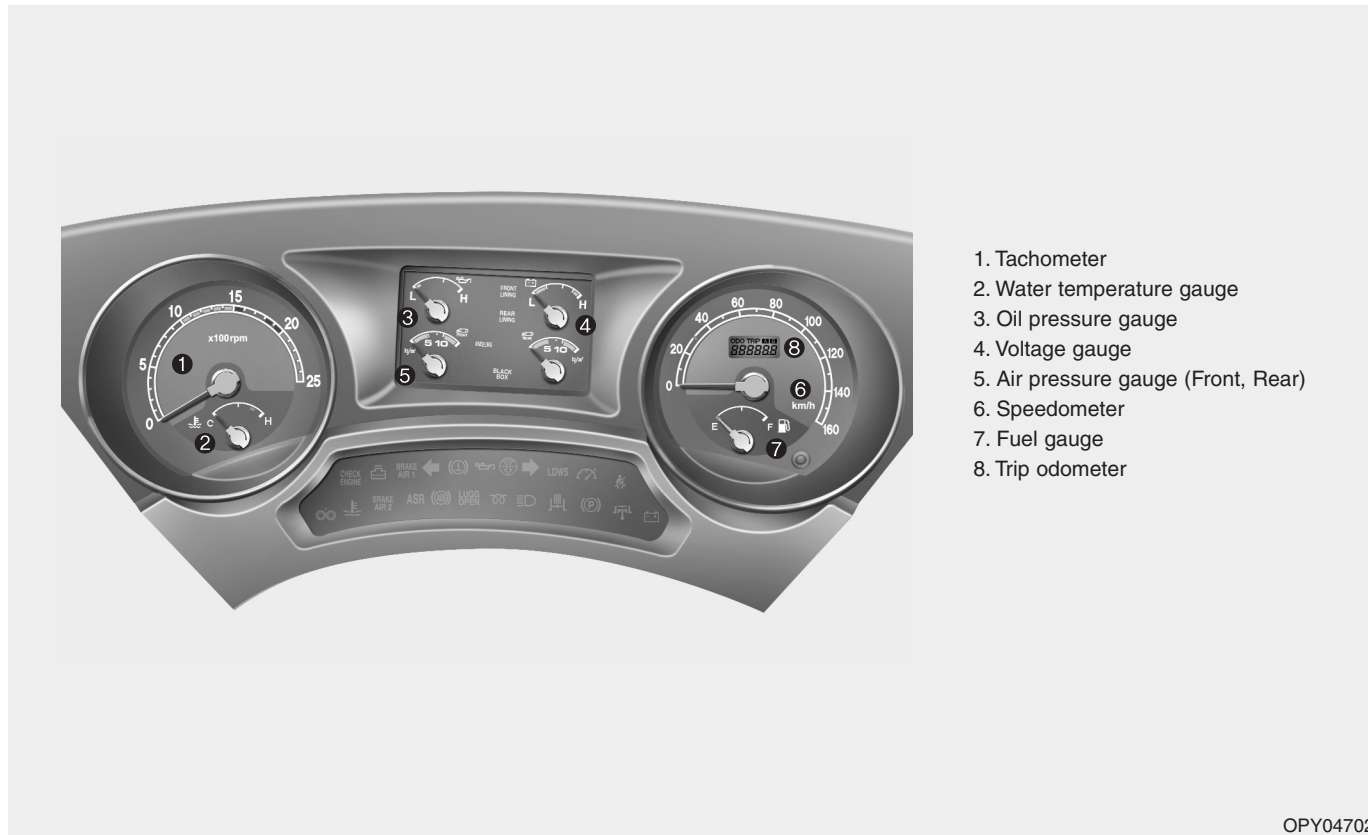

OPY047026

## Instruments & controls

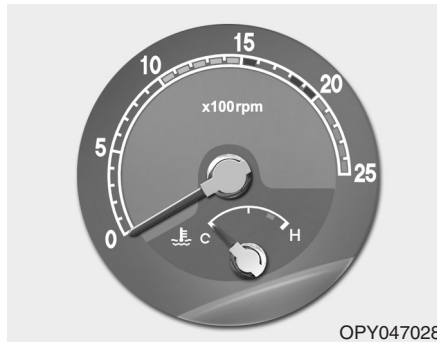

### Tachometer (if equipped)

The tachometer registers the speed of your engine in revolutions per minute (rpm). It is useful to help you shift at the appropriate engine speed to avoid lugging or over revolution.

Blue zone is the best zone for use Jake brake.



### CAUTION

*The engine should not be raced to such a speed that the needle enters the red zone (engine max speed 2,400 rpm) on the tachometer face. This can cause severe engine damage.*

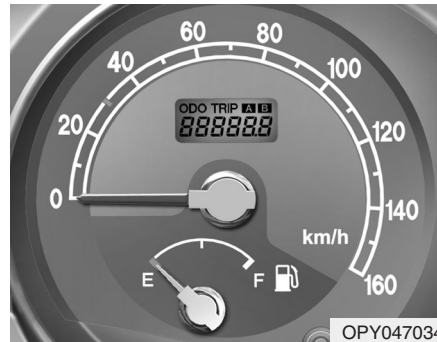

### Speedometer

The speedometer indicates the vehicle speed in kilometers or miles per hour.



### Odometer (if equipped)

The odometer records the total driving distance in kilometers or miles, and is useful for keeping a record for maintenance intervals.





OPY047032

### Air pressure gauge

The air pressure gauge indicates the air pressure in the air reservoir at all times. If the air pressure drops below 4.8-5.2 kg/cm<sup>2</sup>, (  ) the air pilot light comes on and the warning buzzer will sound at the same time. If fails to build up again, stop the engine immediately and contact your authorized dealer.



### CAUTION

*If the air pressure indicates the red zone, do not drive the vehicle. This is very dangerous.*

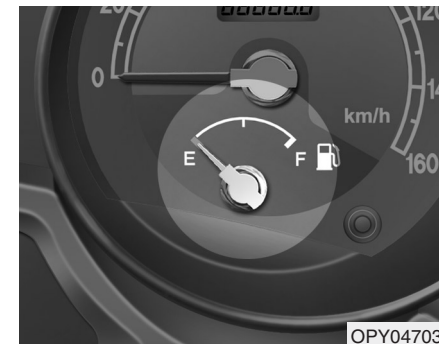

OPY047033

### Fuel gauge

The fuel gauge will indicate the approximate fuel level in the tank, when the ignition is in the "ON" position.

The position of the pointer will vary slightly when accelerating, braking, or when the vehicle is going up or down the hill. So check your fuel supply when the vehicle is more or less specified level, whether standing still or moving.

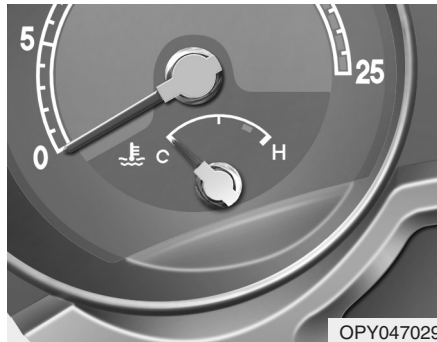

OPY047029

### Water temperature gauge

When the ignition switch is "ON", this gauge indicates the temperature of the coolant. Under most driving conditions, the needle will remain at approximately the halfway point. Stop and go driving, driving at high speeds during warm weather or driving up a steep gradient may cause the pointer to move toward the red sector. If your vehicle overheats, ( 水 ) water lamp comes on and the indicator goes up. However when the quantity of coolant is below of the specification, the warning buzzer will sound.

At this time, stop your vehicle immediately, run the engine at idle and cool the engine.



OPY047031

### Voltage gauge

The voltmeter indicates the battery state of charge. Check while the engine is running. The pointer should always indicate between 20 and 30 volts.

If the pointer reads above 30 volts or below 20 volts, contact your nearest authorized Hyundai dealer.



OPY047035

### Trip odometer

The trip odometer records distance in miles or kilometers. It is equipped with a push-button reset feature. This allows you to return the trip odometer to zero by pushing the small knob at the bottom of the speedometer.



### Oil pressure gauge

The gauge indicates the engine oil pressure while the engine is running.

If the gauge indicates below 0.5 kg/cm<sup>2</sup>, oil warning lamp comes on and buzzer will sound at the same time.

At this time stop the engine immediately and check the lubricating system.

### \* NOTICE

Engine oil pressure when the engine is cold may go up above normal pressure. If the engine is warm, the gauge will indicate normal pressure immediately. If the oil filter is clogged, the oil pressure warning light comes on, but the buzzer will not sound.

## INDICATOR & WARNING LIGHTS



1. Seat belt warning light
2. Turn signal indicator light(Right)
3. Dust warning light
4. Oil pressure warning light
5. Retarder indicator light\*
6. Turn signal indicator light(Left)
7. Air pressure warning light(Front)
8. Low coolant warning light
9. Check engine warning light
10. Charge warning light
11. Jake brake operation indicator\*
12. Parking brake warning light
13. Exhaust brake warning light
14. High beam indicator light
15. Air heater/relay light
16. Luggage open light
17. ABS warning light\*
18. Anti-slip regulator (ASR) light\*
19. Air pressure warning light(Rear)
20. Engine overheat warning light
21. Auto grease warning light
22. Front lining\*
23. Rear lining\*
24. Speed limiter\*
25. Kneeling indicator light\*
26. Auto cruise control light\*

\* : if equipped

OPY047036

**Turn signal indicator lights**

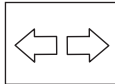

The blinking green arrow on the instrument panel shows the direction indicated by the turn signals. If the arrow comes on but does not blink, blinks more rapidly than normal or does not blink at all, a malfunction in the turn signal system is checked.

**Exhaust brake warning light**



The exhaust brake warning light will be illuminated if the exhaust brake switch is on. Put the exhaust brake switch back in its place where it was and this light goes out.

**Air heater/relay light**



It indicates preheating state of preheat plug.

- When the ignition key turns on, it is illuminated. And it will be turned off when preheating of preheat plug is completed. Start the engine after the indicator lamp is turned off.
- Time to turn off preheat indicator lamp is different according to engine coolant temperature.
- Have the system checked by Hyundai dealer if the preheat indicator lamp continues to flash ON and OFF while driving.

**Dust warning light**



The dust warning light comes on when the air filter is dirty and should be serviced. If this light comes on, clean the air cleaner element according to the vehicle maintenance requirement.

**Parking brake warning light**



This light will be illuminated when the parking brake is applied and the ignition on, and should be extinguished when the parking brake is released. The vehicle should not be driven until the parking brake has been released and the light extinguished.

## Instruments & controls

---

### *Auto grease warning light (if equipped)*



The auto grease warning light is on about 3 seconds when filling on grease at each moving part, then goes out.

This light comes on continuously when trouble occurs on this system.

### *High beam indicator light*



This light is blue-colored and should illuminate only when the head lamp upper beam is on.

### *ABS warning light (if equipped)*



When the key is turned to "ON", ABS warning light will be on and then off in a few seconds.

If ABS warning light remains on while driving, or remains off when the key is turned to "ON", there may be a problem about ABS.

In this case, you should show a HYUNDAI dealer your vehicle and check it as soon as possible.

Though there is a problem about the vehicle, the normal brake system will still operate except ABS.

### *Anti-spin regulator indicator light (if equipped)*



- When the key is turned to "ON" position "ASR" lamp will be illuminated.
- If the brake is engaged, "ASR" lamp goes out. But if it doesn't go out, "ASR" doesn't work.

When there is any problem about "ASR" system, "ASR" lamp is illuminated.

- During normal driving, "ASR" lamp is off. When "ASR" works, "ASR" lamp comes to blink.

### **\* NOTICE**

"ASR" lamp is amber-colored and "ABS" lamp is amber-colored. Amber means INDICATION.

**Air pressure warning light 1, 2****BRAKE  
AIR 1****BRAKE  
AIR 2**

When the air pressure in the air reservoir dropped (below 4.8-5.2kg/cm<sup>2</sup>), the air pressure warning light comes on and the buzzer sounds at the same time. Then stop driving your vehicle immediately and run the engine at idle. Wait until the air pressure gets back and this warning light will go out.

**CAUTION**

*If the vehicle is driven in condition that air pressure warning light comes on, this is very dangerous. If a pressure rising time has a long interval, have the air system checked and repaired by an authorized dealer.*

**Oil pressure warning light**

The oil pressure warning light indicates the engine oil pressure.

1. In normal operation, it should come on when the ignition key is turned on, then go out when the engine is started.
2. The warning light comes on when there is insufficient oil pressure.
3. If the warning light comes on while the engine is running, turn the engine off and check the oil level.
4. If the vehicle is driven with insufficient oil, serious engine damage may result.

**Low coolant warning light**

The low coolant warning light comes on and the buzzer sounds when the coolant of the engine or radiator is approaching empty. When it comes on, you should add coolant as soon as possible. Same ratio as coolant in the radiator should be added.

**Engine overheat warning light**

If coolant is overheated more than the specified temperature, the light illuminates and if it is kept overheated continuously, the "CHECK ENGINE" light may illuminate.

When the coolant overheats warning light illuminates, stop the vehicle and check the coolant quantity and leakage. If the coolant runs short, replenish. In spite of doing it, if the light illuminates continuously, check or repair in the authorized Hyundai dealer.

## Instruments & controls

---

### ***Kneeling indicator light (if equipped)***



The kneeling indicator light comes on continuously while the operating of the kneeling system is in progress with buzzer.

### ***Charge warning light***

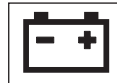

The charge warning light should come on when the ignition key is turned on, then go out when the engine is running. If the light comes on while you are driving, stop and turn off the engine and check the tension of the belt. If the belt is loose or fraying, adjust or replace the belt.

### ***Auto cruise indicator light (if equipped)***



The cruise and speed limit indicator light in the instrument cluster is illuminated only when the vehicle cruising speed has been set using the control switch at the end of the side box.

The indicator light does not illuminate when the main cruise control switch is activated.

### ***Retarder indicator light (if equipped)***



When the retarder works, the amber light on in the instrument.

Also, the indicator lamp flashes ON and OFF when the retarder system is defective.

### ***Jake brake operation indicator (if equipped)***



Jake brake is a kind of the engine brake. When it works, the lamp illuminates but, in case of the vehicle equipped with the exhaust brake or retarder, it doesn't illuminate.

### ***Seat belt warning light***



When the ignition switch is turned on, the seat belt warning light is illuminated to remind the driver to wear their seat belt. If the driver fastens the seat belt, the warning light goes out. When the ignition switch is turned to "ACC" or "LOCK" position, the warning light will also go out.



**Check engine warning light  
(if equipped)**

**CHECK  
ENGINE**

If the main key switch is turned on in normal condition, "CHECK ENGINE" lamp will illuminate and then extinguish after two seconds. If it illuminates continuously, you can suspect any problem in it so have to check or repair in the authorized Hyundai dealer.

**Speed limiter light  
(if equipped)**

**RSL**

If the vehicle speed is over the standard speed, the speed limit warning light comes on, and the standard speed can be different according to the nation.

If there is a malfunction in the system, the light can be also lit.

**Front lining wear light  
(if equipped)**

**FRONT  
LINING**

If the right and/or left brake pads on front wheel brake are(is) worn, the light will come on. If the sensor of front wheel brake is defective, the light will blink.



**CAUTION**

*Have the system inspected by Hyundai dealer as soon as possible if the front lining wear light illuminates or blinks. Replace right and left pads with new ones simultaneously when replacing brake pads.*

**Rear lining wear light  
(if equipped)**

**REAR  
LINING**

If the right and/or left brake pads on rear wheel brake are(is) worn, the light will come on. If the sensor of rear wheel brake is defective, the light will blink.



**CAUTION**

*Have the system inspected by Hyundai dealer as soon as possible if the rear lining wear light illuminates or blinks. Replace right and left pads with new ones simultaneously when replacing brake pads.*

**Luggage open light  
(if equipped)**

**LUGG  
OPEN**

The indicator lamp is illuminated when pressing luggage locking switch after key cylinder of luggage door is locked.

## SWITCHES

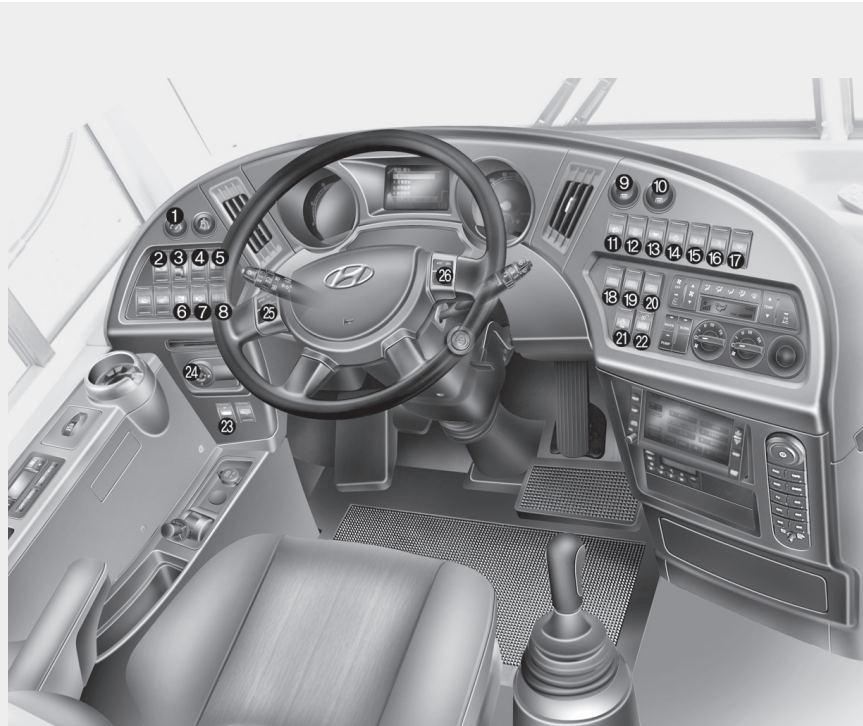

1. Auto cruise control switch\*
2. Cold start switch\*
3. Rheostat switch\*
4. TV switch\*
5. Drive information switch\*
6. Brake selection switch\*
7. Outside rear view mirror heater switch\*
8. Battery relay switch
- 9,10. Mood lamp switch\*
11. Front light switch
12. Driver's light switch
13. Auxiliary lamp switch
14. Head light main switch
15. Floor lamp switch
16. Step floor lamp switch
17. Reading light switch
- 18.~20. Interior light switch
21. Door operating switch
22. Luggage locking switch\*
23. Kneeling switch\*
24. Outside rear view mirror switch\*
25. Audio remote control switch\*
26. Multi-display switch\*

\* The location and option of indicator or switch can differ from depending on vehicle model.

OPY047037L

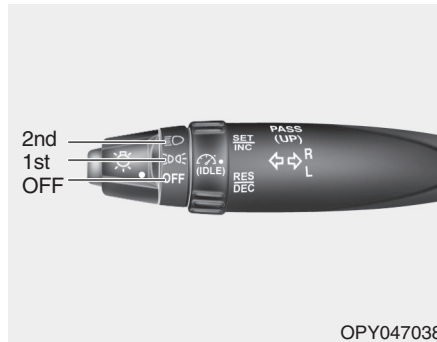

### Headlight switch

To operate the headlights, turn the barrel on the end of the multifunction switch. The first position turns on the parking lights, side lights, tail lights and instrument panel lights. The second position turns on the headlights.

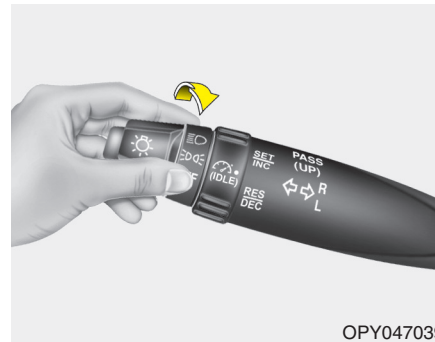

### High and low beam

To turn on the headlight high beams, push the lever. For low beams, pull the lever back (original position). The appropriate headlight beam indicator light will come on at the same time.

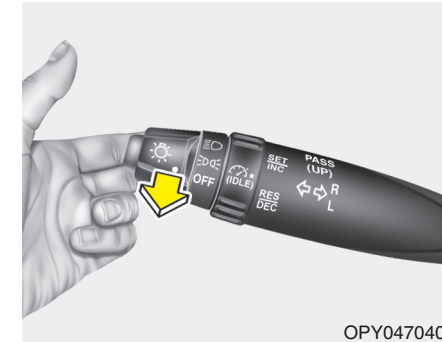

### Passing switch

Pull the lever upward and the head lamp comes on. The lever will automatically return to the original position if it is released.

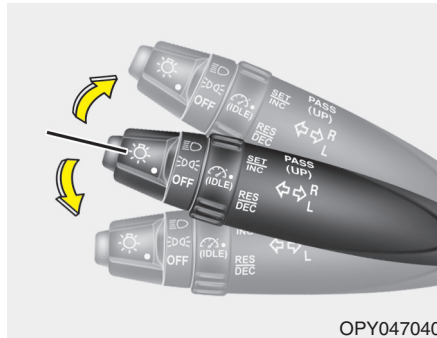

OPY047040

### Turn signal switch

Pulling down the lever causes the turn signals on the left side of the vehicle to blink. Pushing upward the lever causes the turn signals on the right side of the vehicle to blink. As the turn is completed, the lever will automatically return to the center position and turn off the turn signals at the same time.

If either turn signal indicator light blinks more rapidly than usual, goes on but does not blink, or does not go on at all, there is a malfunction in the system. Check for a burned-out fuse or bulb and see your authorized dealer for assistance.

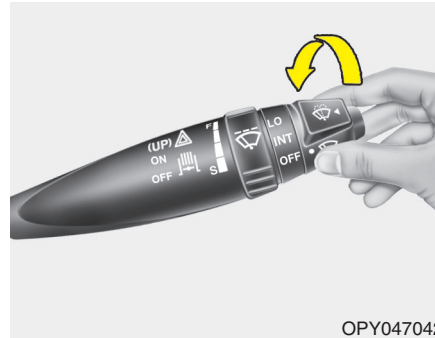

OPY047042

### Windshield wiper switch

The windshield wiper switch has three positions.

INT : Intermittent operation

LO : Low speed operation

HI : High speed operation

### \* NOTICE

To prevent damage to the wiper system, do not attempt to wipe away heavy accumulations of snow or ice. Accumulated snow and ice should be removed manually. If there is only a light layer of snow or ice, operate the heater in the defrost mode to melt the snow or ice before using the wiper.

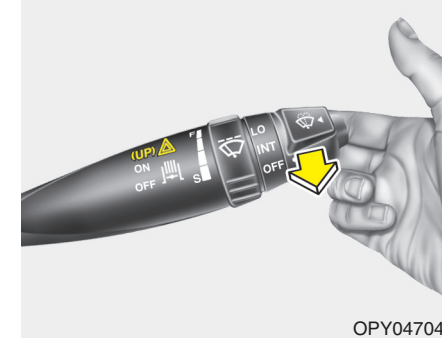

OPY047048

### Hazard warning system

The hazard warning switch should be used whenever you find it necessary to stop the vehicle in a hazardous location. When you must make such an emergency stop, always pull off the roadway as far as possible.

To turn on the hazard warning light, pull the hazard switch. This causes all turn signal lights to blink. The hazard warning lights will operate even though the key is not in the ignition.

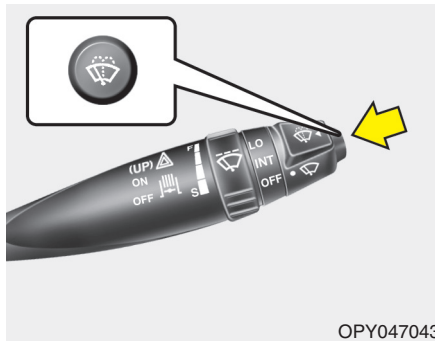

OPY047043

**Windshield washer operation**

To use the windshield washer, press in on the button on the end of the wiper/washer lever. When the washer button is pressed, the wipers automatically make two passes across the windshield. The washer continues to operate as long as the button is depressed.

**CAUTION**

*The washer button should not be pressed if the washer reservoir is empty. This can damage the washer fluid pump. Do not operate the washer for more than 15 seconds at a time.*

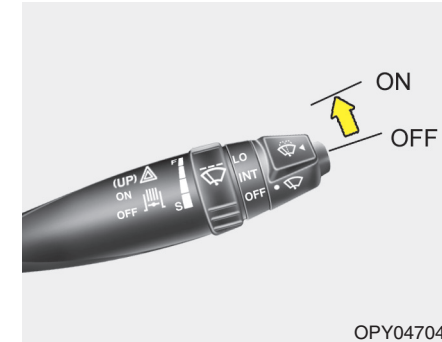

OPY047044

**Exhaust brake switch**

To use the exhaust brake, put the switch "ON" position.

The exhaust brake operates when you remove your foot from the accelerator pedal and the clutch pedal.

The exhaust brake will not operate automatically if you operate the accelerator pedal or the clutch pedal.

Use exhaust brake when going down a slope.

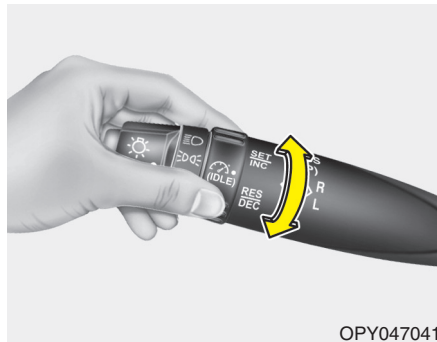

### Idle (RPM) control switch (if equipped)

Use the idle control switch when the engine idle rpm is unstable in case the engine is started at winter season or the auxiliary systems like air conditioning system are used.

To operate the system, put the lever in the neutral condition and start the engine after applying the brake pedal. Make sure that the main cruise control switch in the instrument is turned off.

Whenever the idle control switch is moved to “SET/INC”, the idle speed will be increased at the rate of 25rpm. On the contrary, whenever the idle control switch is moved to “RES/DEC”, the idle speed will be decreased at the rate of 25rpm.

When you start the engine next, it is started with the idle rpm changed into the number adjusted newly. Adjust the idle rpm in case the engine noise occurs at idle.

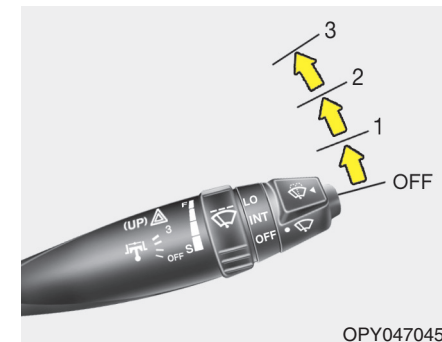

### Jake engine brake (if equipped)

Jake engine brake is a diesel engine retarder. ECU operates the magnetic valve of the jake brake installed on the cylinder head according as a driver turns the switch on or off and has worked the engine such as an air compressor. This makes the drive wheels spin slowly.

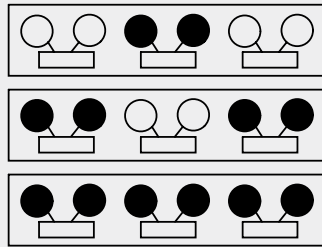

MA59682

The Jake engine brake is a vehicle-slowing device, not a vehicle-stopping device.

**First gear** : operates the #3, 4 cylinder and yields 1/3 total braking horse power.

**Second gear** : operates the #1, 2, 3, 4 cylinder and yields 2/3 total braking horse power.

**Third gear** : operates the #1, 2, 3, 4, 5, 6 cylinder and yields full braking horse power.

You can obtain maximum retarding power when you use the lowest possible gear without exceeding the recommended RPM for engine braking.

#### **Condition for operating jake brake**

- The engine reaches full operating temperature.
- The number of engine revolution is more than 900 RPM.
- Fuel isn't injected.
- ABS doesn't work.
- Exhaust (or Jake) Brake Switch is turned on.
- Auto Cruise Control System isn't applied.
- If the Jake engine brake is turned on once, when the clutch pedal is not depressed the Jake brake is automatically worked.



#### **CAUTION**

- *When you do not use the Jake engine brake, the switch must be in the OFF position.*
- *If the Jake engine brake is new to you, do not attempt to use until you have some experience with it on dry pavement.*
- *Since the operation of any vehicle under slippery condition is unpredictable, do not use.*
- *If the drive wheels begin to lock or there is a fishtail motion, immediately turn the switch off and don't turn the Jake engine brake on until road condition improve.*
- *If the engine brake is on, shifting without depress the clutch pedal can be damaged the engine.*

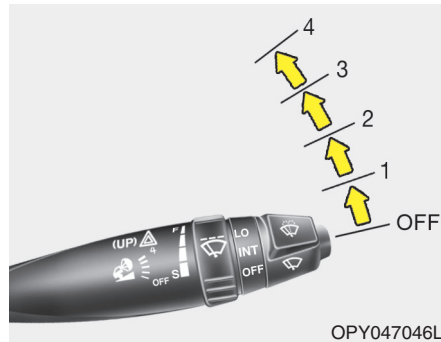

### Retarder brake (if equipped)

Retarder brake is used when brake pedal is depressed frequently like downhill roads.

Using retarder brake is to help safe driving as well as to extend replacement interval of brake lining and brake pad by using fluid resistance.

### How to operate

1. Turn on retarder switch made on the multi-function switch. Retarder switch ranges from 1st step to 4th step.

The range of reduction of speed for retarder is as follows:

- 1st step: Generally this step is used to drive long downhill roads by controlling that the vehicle is accelerated by the force of gravity. (Bremsomat function)
- 2nd step: 40% of range of total reduction of speed
- 3rd step: 80% of range of total reduction of speed
- 4th step: 100% of range of total reduction of speed

2. When the accelerator pedal is depressed, retarder is not operated and indicator light is turned off. And when the accelerator pedal is released from foot, retarder is operated and vehicle speed is decreased. At the same time, the indicator light is illuminated.

### CAUTION

*The heat that is generated when retarder is operated is cooled down in engine radiator. If coolant temperature rises to red reading of gauge to protect engine, brake force will be weakened in sequence. Shift retarder lever as sequentially as possible from lower gear to higher gear. Brake force will be recovered if coolant temperature becomes low.*



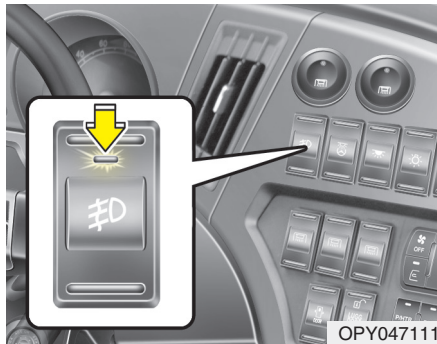

#### Front fog light switch (if equipped)

Use the front fog light switch when you are not able to see because of the fog. The front fog light comes on when the fog light switch is in the "ON" position. During operating this switch clearance lamp, tail lamp, license plate light, instrument lights will come on at the same time.

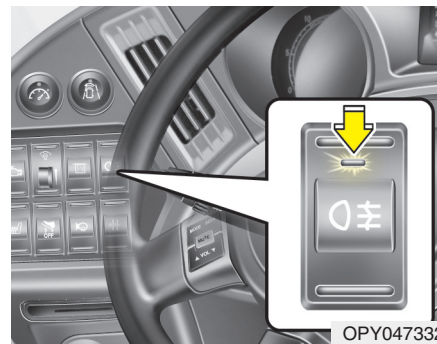

#### Rear fog light switch (if equipped)

Use the rear fog light switch when you are not able to see because of the fog. The rear fog light comes on when the fog light switch is in the "ON" position. During operating this switch clearance lamp, tail lamp, license plate light, instrument lights will come on at the same time.

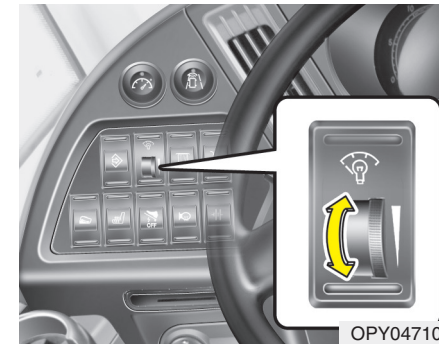

#### Rheostat switch (if equipped)

The instrument panel lights can be made brighter or dimmer by turning the instrument panel light control knob.

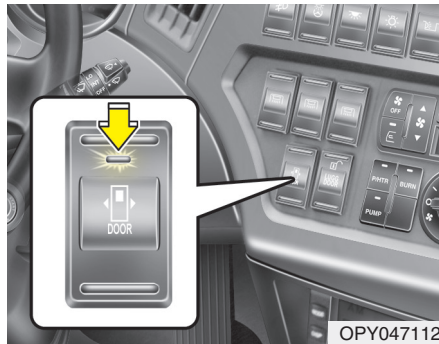

### Door operating switch

The door will be opened or closed by the switch.

#### CAUTION

- *Do not open the door for a long time. The battery can be discharged.*
- *When closing door, the operation of air conditioner or front heater can be weak or be stopped temporarily. When door is closed fully, the operation will return to normal.*

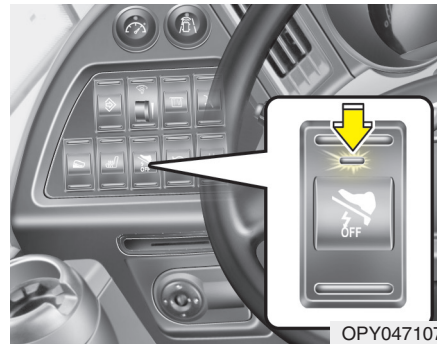

### Brake selection switch

If the brake selection switch is in ON position, exhaust brake, jake brake or retarder brake can not be applied in connection with the foot brake. If the brake selection switch is in OFF position, the brake selection switch is illuminated and exhaust brake, jake brake or retarder brake can be applied in connection with the foot brake.

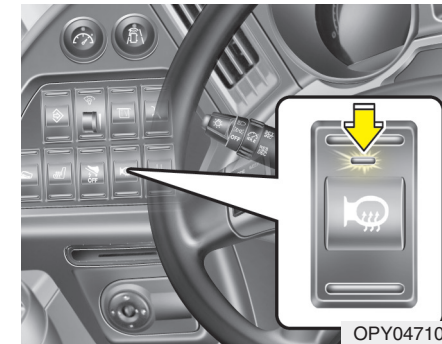

### Outside rear view mirror heater (if equipped)

Depress the switch to heat the rear view mirror glass. The rear view mirror glass will be heated for defrosting or defogging and will give you improved rear view in all weather conditions. Depress the switch again to turn the heater off.

#### CAUTION

*Be sure to turn off the switch when it is not in use. Otherwise the battery will be discharged.*

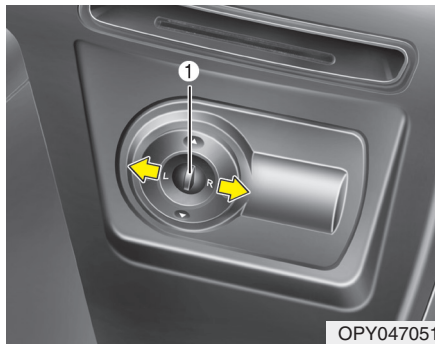

OPY047051

**Outside rear view mirror  
(if equipped)*****Electric type***

The outside rear view mirror can be adjusted in any direction to give the maximum rear view vision.

The remote control outside rear view mirror switch controls the adjustments for both right and left door mirror.

**To adjust the position of either mirror:**

1. Move the selecting switch to the right or left to activate the adjustable mechanism for the corresponding door mirror.
2. Now, adjust mirror angle by depressing the appropriate perimeter switch as illustrated.

**CAUTION**

- *Do not operate the switch continuously for an unnecessary length of time.*
- *Scraping ice from the mirror face could cause permanent damage. To remove any ice, use a sponge, soft cloth or approved de-icer.*
- *If the mirror control is jammed with ice, do not attempt to break it free using the control handle or by manipulating the face of the mirror. Use an approved spray deicer (not radiator antifreeze) to release the frozen mechanism or move the vehicle to a warm place and allow the ice to melt.*

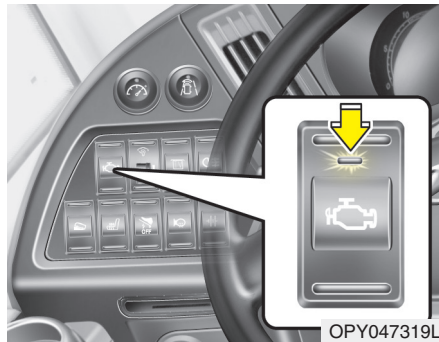

### Cold start switch (if equipped)

In cold weather to facilitate starting, press the cold start switch. Then the amber lamp ( ) will come on. The amber lamp will be off after about 20 seconds.

If the lamp is off, start the engine. If the engine is started, press this switch to the "OFF" position. Then the switch will be in the "OFF" position.

### \* NOTICE

Use this switch mostly above  $-5^{\circ}\text{C}$ . Be sure to be in "OFF" position before driving when the engine is fully warmed up. If the temperature is below about  $-5^{\circ}\text{C}$ , senses all conditions automatically and preheats the engine.

When the starting is completed, the pre-heater is automatically "OFF".

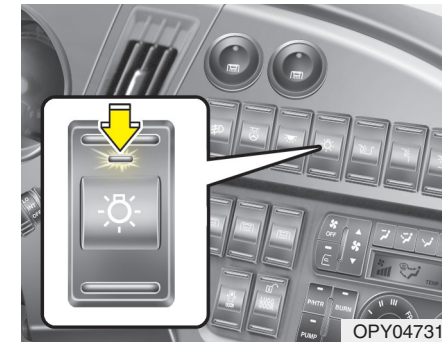

### Headlight main switch (if equipped)

The switch is used when he wants to notify the front vehicle or the opposite vehicle of that his vehicle is driving during the daytime for safety. If the switch is pressed, the high-beam will turn on.

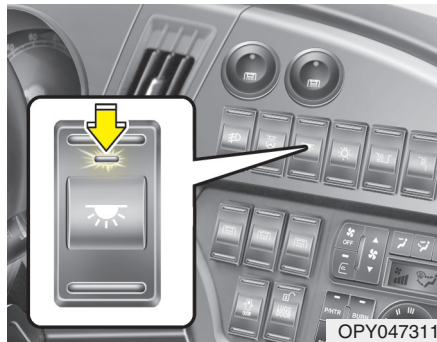

OPY047311

#### Auxiliary light switch

Press the auxiliary light switch to turn the 2nd line light on. Press it again to turn off.

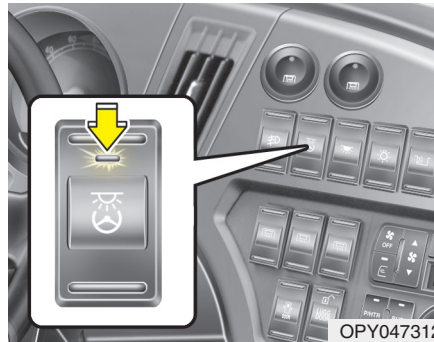

OPY047312

#### Driver's light switch

Press the driver's light switch to turn on driver's light in the upper of driver seat. Press it again to turn off. Turn off while driving.



OPY047313

#### Step floor lamp switch

Press the step floor lamp switch to turn on the step light in the door. Press it again to turn off.



### Reading light switch

Press the reading light switch to turn on the reading light. Press it again to turn off. The reading light in the passenger seat can not be turned on if the reading light switch is turned off.

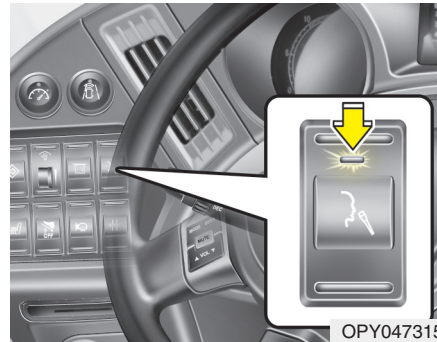

### Driving information switch (if equipped)

Press the driving information switch to use microphone.

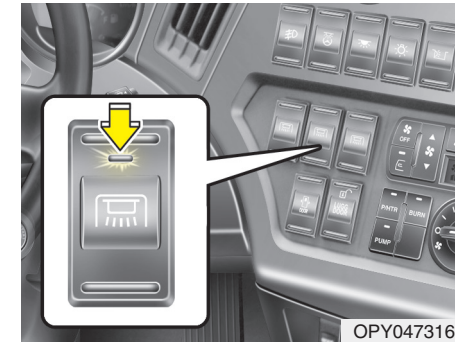

### Interior light (Front 1,2) switch (if equipped)

Press the interior light switch to turn on the interior light.

Press it again to turn off.

Interior switch front: Light on from 1st row to 2nd row in front

Interior switch 1: Odd number light on

Interior switch 2: Even number light on

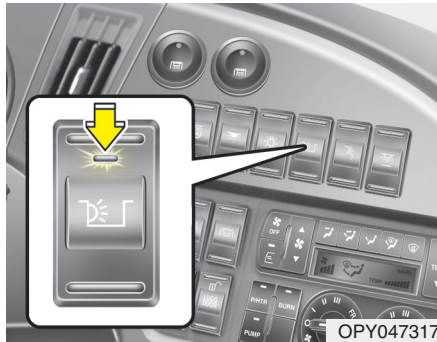

#### Floor lamp switch

Press the floor lamp switch to turn on gangway mood light. Press it again to turn off.

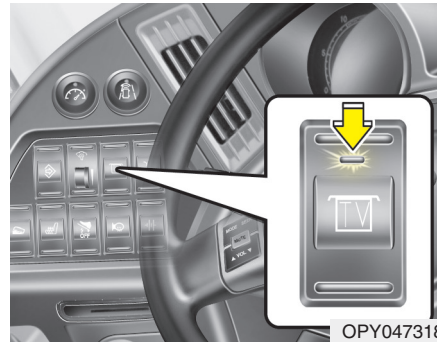

#### TV main switch (if equipped)

Press the TV main switch to turn on the television.

For more detailed information, refer to the TV manufacturer's guide manual.

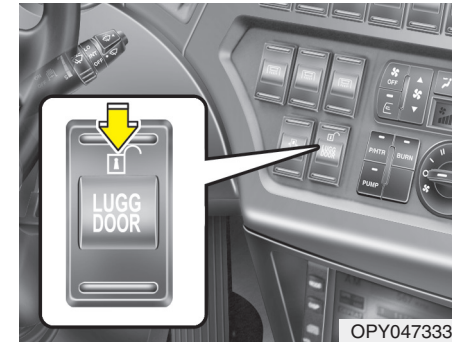

#### Luggage locking switch (If equipped)

##### *Closing and opening luggage door with luggage locking switch*

After luggage locking system is locked, luggage locking system will be released when pressing luggage locking switch. And if you press it again, door can not be opened as locking system is already locked.



### \* NOTICE

When battery relay switch turns on and ignition key is in "ON" position, door switch is operated.

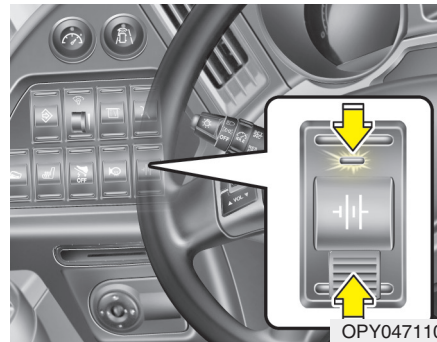

### Battery relay switch

The battery relay switch is the main switch for the electric circuits.

Each time the knob is depressed, the switch is alternately turned on and off. When the switch is "ON", the pilot lamp in the knob lights. When the switch is "ON", all the switches and gauges operate. The hazard lamp can be operated regardless of this switch, as it is directly connected to the battery.



### CAUTION

*Be sure not to place the battery relay switch in the "OFF" position when the engine is running, as there is a danger of failure of the electrical system. Moreover, since the gauge and switches do not operate. It can be very dangerous. To turn off the switch, depress the switch to the "OFF" position. Make sure that the battery relay switch is "ON" when starting the engine.*

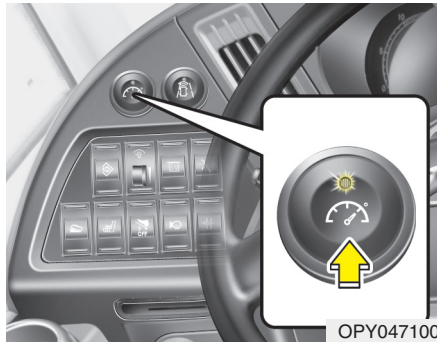

**AUTO CRUISE CONTROL (IF EQUIPPED)**

If you turn on the cruise selection switch for the speed that a driver wants and then push the auto cruise switch, auto cruise system will be applied though the accelerator pedal is not pressed.

**Conditions for operating auto cruise**

- Vehicle speed is more than 40 km/h.
- Vehicle is not in neutral.
- Parking brake isn't applied.
- RPM is over the specified value.
- Brake/clutch pedal isn't depressed.
- Auxiliary (Exhaust/Jake) brake isn't applied.
- Auto cruise selection switch is turned on.

**How to change the speed while driving**

- If you increase the vehicle speed by depressing the accelerator pedal and then release it, auto cruise system is applied at the established speed.
- When you push the auto cruise switch, the vehicle speed increases but if you release the switch, auto cruise system is applied at the speed fixed when it increases (it is limited to the maximum speed of auto cruise system).
- When you push the auto cruise switch in the opposite direction, the vehicle speed decreases but if you release the switch, auto cruise system is applied at the speed fixed when it decreases.

### Conditions for cancelling auto cruise

- Vehicle speed is less than 40 km/h.
- Vehicle is in neutral.
- Parking brake is applied.
- RPM is under the specified value.
- Brake/clutch pedal is depressed.
- Auxiliary Exhaust/Jake brake is applied.
- Auto cruise selection switch is turned off.

### How to return to auto cruise system after cancelling

If you turn the auto cruise switch off and on again, then off to decrease the speed, it returns to the established speed previously.

(But the speed doesn't return to with the cruise selection switch off)

## KNEELING SYSTEM (IF EQUIPPED)

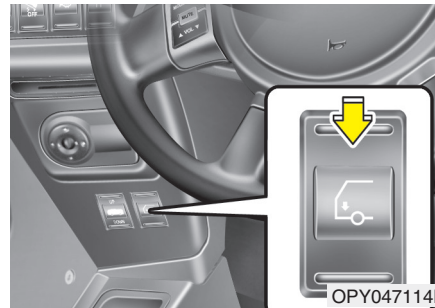

Kneeling system is designed to bring the front of the vehicle down. It can be easy to get on or off the vehicle.



### To bring down the height of the vehicle

1. Check to be sure the parking brake is engaged.
2. Depress the switch to "DOWN" side, the buzzer sounds at the same time.
3. Kneeling indicator light (amber) comes on simultaneously.
4. After 3 seconds later, the height of the vehicle will bring down for 5 seconds.

**To return the height of the vehicle**

1. Depress the switch to "RETURN" side, the buzzer and indicator light operate at the same time.
2. After 3 seconds later, the height of the vehicle will return to the original height for 60 seconds.

**CAUTION**

*If the parking brake is not engaged, the kneeling system can not be operated.*

*While operating the kneeling system, if the parking brake release, this system will be stopped. And the height of the vehicle will return its usual.*

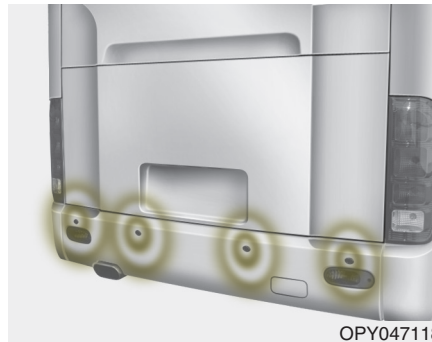
**REAR PARKING ASSIST SYSTEM (IF EQUIPPED)**

This system features the supersonic wave sensors in the rear bumper which measure the distance from the nearest object. It warns the driver when the vehicle approaches an object to prevent possible damage to the bumper. The warning signal will alert 3 intervals according to the distance (about 0.5m, 1 m, 1.5m).

**\* NOTICE**

- Back warning system should only be considered as a supplementary function. The driver must check the rear view.
- The audible warning signal might not activate in case the sensor is frozen or stained with dirt or mud.
- There is a chance of malfunction of the back warning system when driving in uneven surfaces such as woods, gravel road, jagged road, or gradient.

**WARNING**

**If you don't hear an audible warning sound or if the buzzer sounds intermittently when shifting the gear to "R" position, this indicates a malfunction in the back warning system. If this occurs, have your vehicle checked by your Hyundai dealer as soon as possible.**

## POWER OUTLET

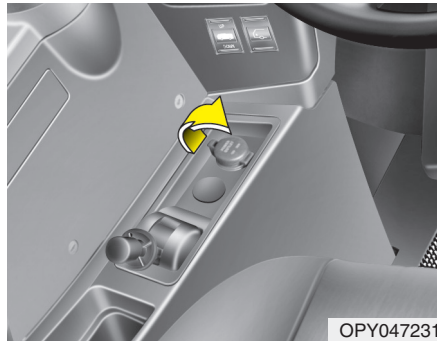

Uncover the power outlet cover to use it. The power outlet is designed to provide power for the electrical devices (vacuum cleaner, small sized refrigerator or AV gamer etc.). The devices should draw less than 12V, 3A with the engine running.

### CAUTION

- *Use power outlet only when the engine is running and remove the accessory plug after use. Using the accessory plug for prolonged periods of time with the engine off could cause the battery to discharge.*
- *Only use 12V electric accessories which are less than 3A in electric capacity.*
- *Close the cover when not in use.*
- *Some electric devices can cause electronic interference when plugged into a vehicle's power outlet. These devices may cause excessive audio static and malfunctions in other electronic systems or devices used in your vehicle.*

## CLOCK

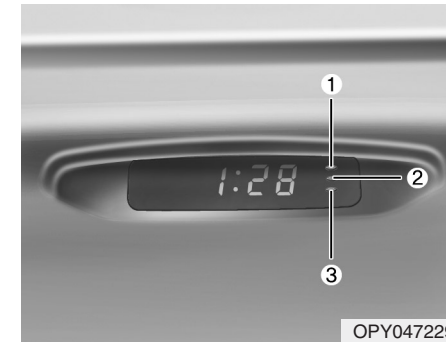

### Digital clock (if equipped)

There are three control buttons for the digital clock. Their functions are:

1. HOUR - Push "H" to advance the hour indicated.
2. MIN - Push "M" to advance the minute indicated.
3. RESET - Push "S" to reset minutes to ":00" to facilitate resetting the clock to the correct time.

When this is done:

Pressing "S" between 10 : 30 and 11 : 29 changes the readout to 11 : 00. Pressing "S" between 11 : 30 and 12 : 29 changes the readout to 12 : 00.



### Analogue clock (if equipped)

Analogue clock can be adjusted by turning the control knob. Press the button on the flank of the clock and turn the control knob to adjust the correct time clockwise or counterclockwise.

### THERMOS/REFRIGERATOR (IF EQUIPPED)



Use the thermos or refrigerator when keeping food in good condition.

### AIR CONNECTOR (IF EQUIPPED)

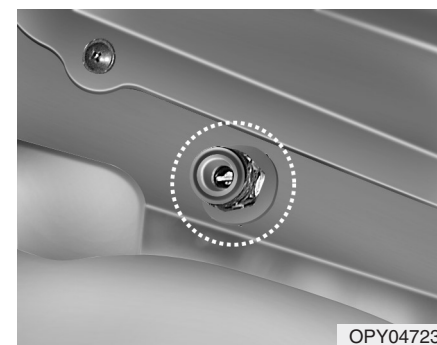

The air connector on the left floor of front of driver's seat is designed to provide the compressed air for cleaning the vehicle interior. The air should be drawn with the engine running. Otherwise, you can use the compressed air until the air in the tank is used up.

## STEERING WHEEL & HORN

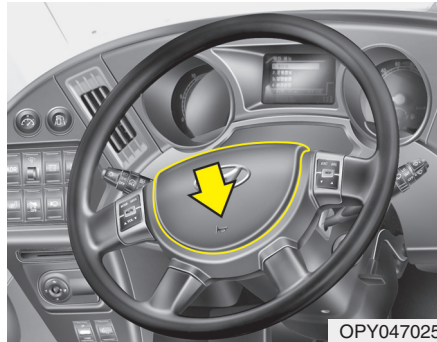

Your Hyundai is equipped with integral styled steering wheel. The horn button is located on the center of the wheel. The horn sounds when the horn button is pressed firmly.

## PARKING BRAKE

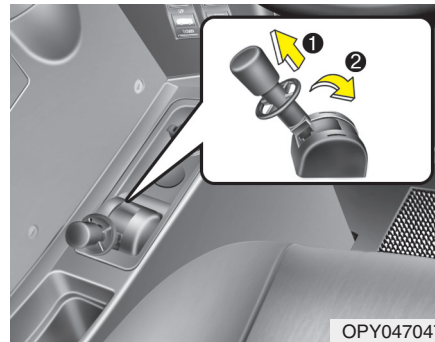

Always engage the parking brake before leaving the vehicle. This also turns on the parking brake indicator light when the key is in the "ACC" or "ON" position. Before driving away, make sure that the parking brake is fully released and that the indicator light is off.

- To engage the parking brake, pull the lever (1) toward the rear of the vehicle
- To release the parking brake, push the lever toward the front of the vehicle after pull the locking knob out slightly.

## ANTI SPIN REGULATOR (IF EQUIPPED)



Anti spin regulator is a device added to the anti lock brake system. The ASR controls the rear wheels spin according to the friction between a wheel and the road. The ASR makes stability and bearings for direction when a vehicle starts or turns a corner.

### \* NOTICE

If one of the ABS or ASR is out of order the ABS warning light is illuminated. The ASR lamp is on if the engine control line is out of order even though the ASR system is working normally.

**Inspection the system**

1. Turn the ignition key to the ON position then the ABS warning light will be on and the ASR lamp be also on. Depress the brake pedal and the lights will be off to indicate the system is normal.
2. If the ASR light is illuminated continuously turn the ignition switch off. Try again above procedure and check the light is off. If not, the system should be damaged.

**\* NOTICE**

Though the system is damaged it is possible to drive the vehicle but be careful in moving on the slippery road.

3. Start your engine.
4. If the speed reach 6~10 km/h the ABS warning light will be off to indicate the system is normal.
5. If not, stop your vehicle and try above procedure No.3 and 4 again. If the light is on continuously the system should be damaged and make it be checked by an authorized Hyundai service station.

**CAUTION**

- *When the ASR is working RPM can decrease even though the accelerator pedal is depressed fully that is normal condition.*
- *Although the ASR/ABS is applied to the brake in short time, the braking distance may vary according to the road conditions. Always maintain a safe distance between your car and objects ahead.*

## ANTI-LOCK BRAKE SYSTEM (IF EQUIPPED)

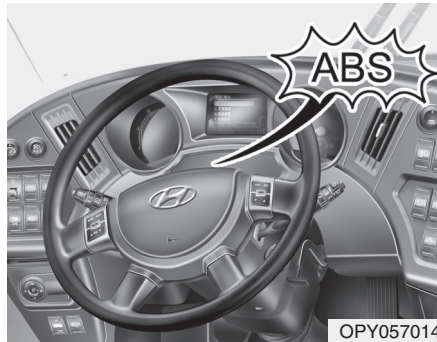

The Anti-Lock Brake System (ABS) is designed to prevent wheel lock-up during sudden braking or on hazardous road surfaces. The ABS control module monitors the wheel speed and controls the pressure applied to each brake. Thus, in emergency situations or on slick roads, your ABS will increase vehicle control during braking.

### \* NOTICE

During ABS operation, a slight pulsation may be felt in the brake pedal when the brakes are applied. Also, a noise may be heard in the engine compartment while driving. These conditions are normal and indicate that the anti-lock brake system is functioning properly.

### ⚠ WARNING

Your ABS will not prevent accidents due to improper or dangerous driving maneuvers. Even though vehicle control is improved during emergency braking, always maintain a safe distance between you and objects ahead. Vehicle speeds should always be reduced during extreme road conditions.

The braking distance for cars equipped with an anti-lock braking system may be longer than for those without it in the following road conditions.

- Driving on rough, gravel or snow-covered roads.
- Driving with tire chains installed.
- Driving on roads where the road surface is pitted or has different surface height.

During these conditions the vehicle should be driven at reduced speeds. The safety features of an ABS equipped vehicle should not be tested by high speed driving or cornering. This could endanger the safety of yourself or others.

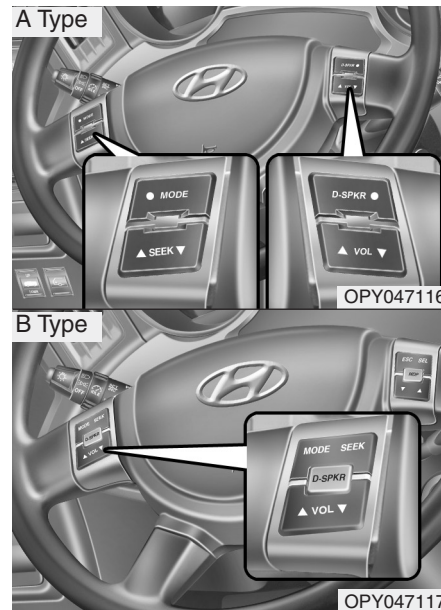

**AUDIO REMOTE CONTROL SWITCH (IF EQUIPPED)**

The steering wheel audio remote control button is installed to promote safe driving.

**CAUTION**

*Do not operate audio remote control buttons simultaneously.*

**Mode**

Press the button to select Radio, Tape(if equipped).

**Seek**

When the (+) side is pressed, the unit will automatically tune to the next higher frequency and when the (-) side is pressed, it will automatically tune to the next lower frequency.

**Vol**

Press the up button to increase volume. Press the down button to decrease volume.

**D-SPK**

It changes the sound direction of driver's or passenger's seat side.

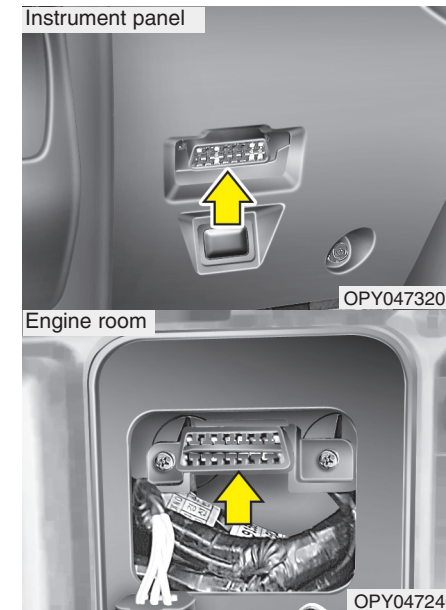
**DIAGNOSTIC CONNECTOR**

The diagnostic connector is designed to check the engine malfunction with the scan tool.

## AUXILIARY STARTER SWITCH IN ENGINE ROOM

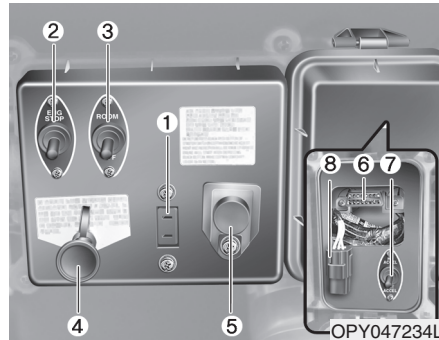

1. Outlet
2. Engine stop switch (if equipped)
3. Engine room lamp switch
4. Stater safety switch
5. Stater switch
6. Diagnostic connector
7. Accel assistant switch
8. Accel assistant pedal connector

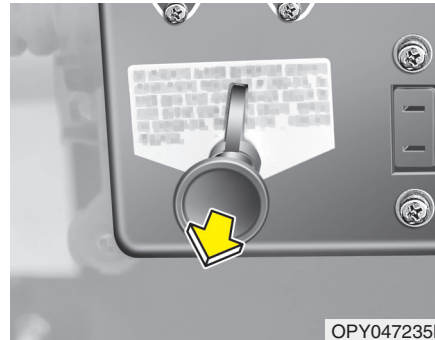

### Starter safety switch

Pull the starter safety switch in the engine room out and hang the stopper on the shaft for the sake of safety when working in the engine room. This causes the electricity to cut off. And the engine is not started.

### \* NOTICE

Be sure to check that the starter safety switch hangs the stopper on the shaft for safety during inspection or repair the engine and the engine accessories.



### Starter switch

Press the starter switch, then the engine is started.

### \* NOTICE

Be sure to place the gear shift lever to "NEUTRAL" position. Do not use the starter switch without checking the engine. Be sure to apply the parking brake for safety and apply chocks to the tires.

Use the starter switch only when the ignition key is "ON" position.



#### Engine room light

Turn the engine room light on and it will be illuminated.

#### \* NOTICE

Be sure to turn the engine room light off when leaving the engine room. If not, the battery will be discharged.

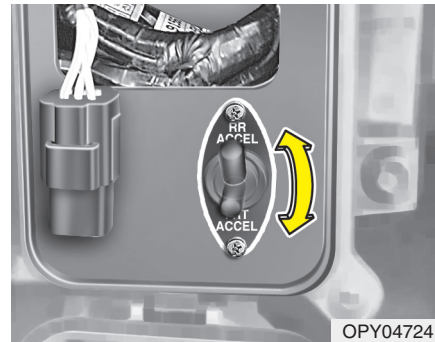

#### Accelerator auxiliary switch (if equipped)

The accelerator auxiliary switch is designed to check the engine from the engine compartment. Select the accelerator auxiliary switch to "RR ACCEL" when you want to accelerate the engine using the accelerator auxiliary pedal terminal connector. Be sure to put the accelerator auxiliary switch into "FRT ACCEL" after use.

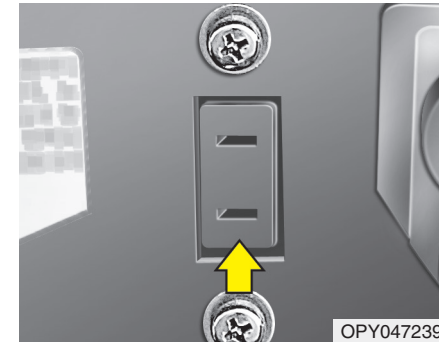

#### Outlet

A rated current capacity should not be over 10A (24V-240W).

#### **⚠ WARNING**

**Do not connect the electric device of which capacity is over the permitted capacity, otherwise overheat or fire can be caused on the plug.**

## TACHOGRAPH (IF EQUIPPED)



### VDO Tachograph (if equipped)

- : Chart plate extract button
- : Time adjustment and current error message display button
- : Time adjustment and error memory display

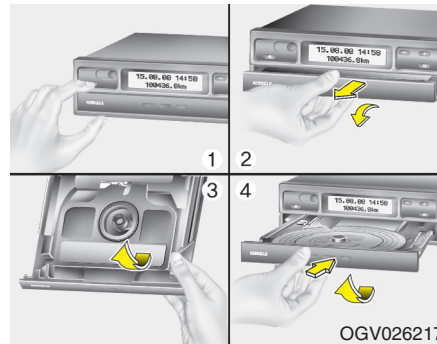

1. Display: Date, time, total travel distance
2. When opening chart plate
  - Press button.
  - Pull it out with chart plate extracted state.
  - Push it back when closing it.

### Time adjustment

1. Press button.

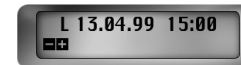

2. "Minutes" display will flash.

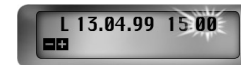

3. Adjust the desired minutes by using +, - button.

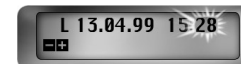

4. Press button again and then hour display will blink.



5. Adjust the desired hours by using +, - button.

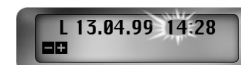

6. Press button for 2 sec. or more to return the original screen.



**Error memory display**

1. The cause of error can know if the function of the error memory is used.

**CAUTION**

**The function of the error memory should be used after the vehicle is stopped.**

2. Select the error memory menu by pressing **M** button two times.
3. Make sure that there is other error memory by using **M** button.
4. Press **M** button for more than 2 sec. or leave it for more than 20 sec. untouched to return the original screen.

Code	Description
9053	Tachograph will change into the start or end of daylight saving time automatically. Time is adjusted with the stored chart. Update chart carrier.
9064	Clock of screen is blinked. Error while updating chart carrier adjustment. Update chart carrier adjustment one more time.
9064	Screen is not blinked. Chart carrier operation functions improperly. Check that chart is inserted correctly.
A050	There is operated without chart. Insert the chart.
9064	There is no chart. Insert the chart.
900A 900B	Error during transmitting with CAN.
A00C	Inside error
900F	Key pad error [Key is depressed for a long time or is blocked.]
9010	LCD error(screen)
9060	Chart plate error. Close plate again after performing the procedure of opening plate.
9061, 9062, 9063	Error to recording system (Tachograph records the errors to chart.)
9430	Error from "B7" V-pulse output
A411	No connection to instrument
A423	Error during communicating with pulse generator (Tachograph records the error to chart.)
A822	Pulse generator key, serial number, error of signal (Tachograph records the error to chart.)
A400	Power loss (Error code is not detected in error memory. Tachograph records the errors to chart.)

### Remedy of error

Message will be deleted automatically after most of errors are repaired



### CAUTION

**Inspect immediately if same message repeats.**

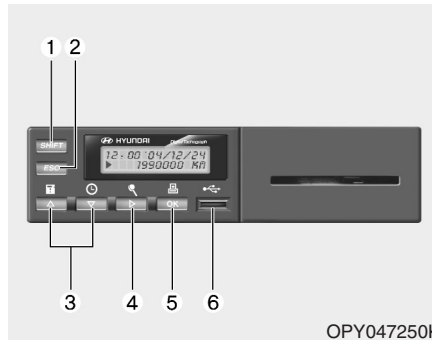

### Digital tachograph (If equipped)

#### Name and function

#### 1. SHIFT

The button is used for combining when moving from initial screen to desired menu.

#### 2. ESC

The button is used for moving to upper menu when the button is depressed for more than 0.1 sec.

#### 3. ▲▼

If ▲ or ▼ button is depressed for more than 0.1 sec., you can move between menus or select. The position of cursor continues to increase or decrease.

#### 4. ◀ ▶

If ◀ or ▶ button is depressed for more than 0.1 sec. on the menu, you can move between menus or select. The value of digits increases or decreases.

#### 5. OK

If OK button is depressed for more than 0.1 sec in all menus, you can select, download driving record or print.

#### 6. USB

You can store driving information in the USB stick memory.



### CAUTION

- **Do not use USB stick memory incompatible with the unit.**
- **Key pad or menu will not be selected since the driving record is in operation while the vehicle is driving.**

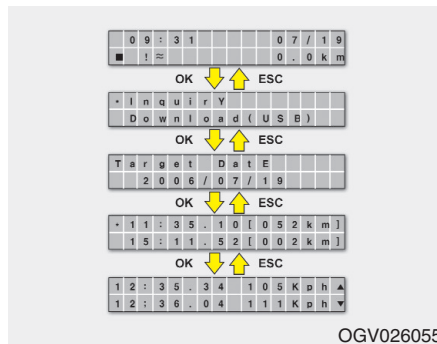

OGV026055

#### Driving information seek

1. Press OK key for more than 1 sec.
2. Select inquiry menu.
3. Select the date to seek.
  - Using [▲], [▼] key, seek(increase, decrease) the date.
  - The date that the driving information does not exist is not displayed.
4. Using [▲], [▼] key, select the desired driving record in driving lists to seek.
5. Using [▲], [▼] key, seek the contents.

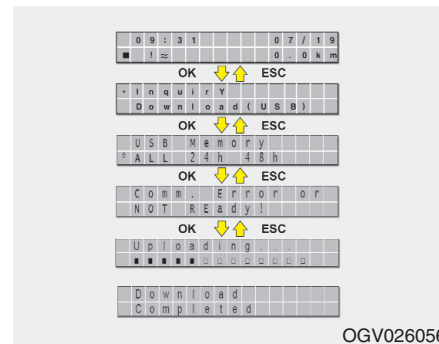

OGV026056

#### Download transmission

1. Press OK key for more than 1 sec.
2. Select Download menu.
3. Select tachograph.
  - Using [▶] key, select the period to download.
4. In case the USB memory stick is not connected or communication is impossible, the following message will be displayed.
5. If the Download is in operation normally, the next message will be displayed.
6. If the download is completed, the procedure will be ended after the next message is displayed.

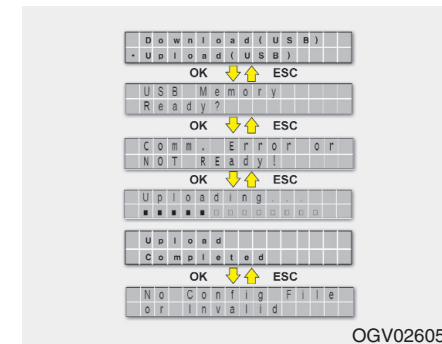

OGV026057

#### Upload transmission

1. Press OK key for more than 1 sec.
2. Select Upload menu.
3. Press OK key to start Upload.
4. In case the USB memory stick is not connected or communication is impossible, the following message will be displayed.
5. If the Upload is in operation normally, the next message will be displayed.
6. If the Upload is completed, the procedure will be completed after the next message is displayed.
7. In case the file to Upload was not detected or arbitrarily modified file exists, the next message is displayed.

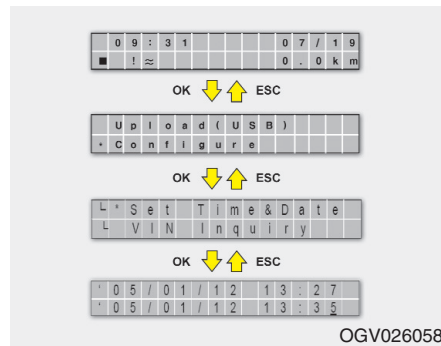

### Current time setup

1. Press OK key for more than 1 sec.
2. Select Configure menu.
3. Select Set Time & Date.
  - 1) Using [◀], [▶] key, you can move current date(year, month, date). And using [▲], [▼] key, you can setup current date.
  - 2) Press OK key to setup the desired date.
  - 3) Press ESC key to cancel the desired date.

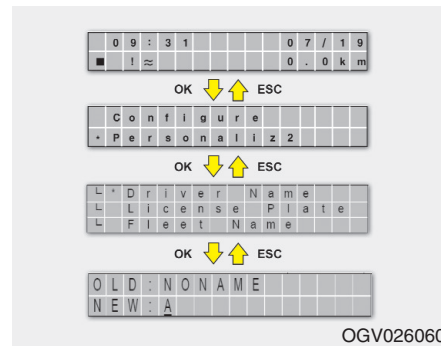

### Driver's name setup

1. Press OK key for more than 1 sec.
2. Select Personalize menu.
3. Select Driver Name.
  - 1) Using [▶] key, you can select the position to change.
  - 2) Using [▲], [▼] key, you can change driver's name.
  - 3) Press [Shift+▶] to move the position of character backward.
4. Total twelve characters are available to input.
5. Press OK key to setup the changed content.
6. Press ESC key to cancel the changed content.

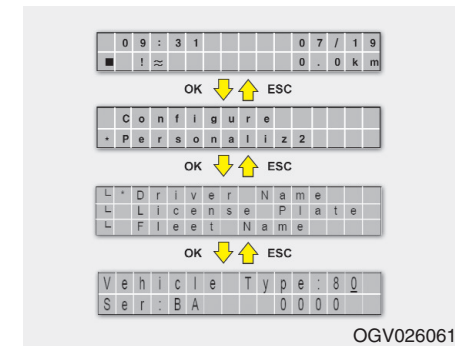

### License number setup

1. Press OK key for more than 1 sec.
2. Select Personalize menu.
3. Select License Plate.
  - 1) Using [▶] key, you can select the position to change.
  - 2) Using [▲], [▼] key, you can change license number.
  - 3) Press [Shift+▶] to move the position of character backward.
4. Total twelve characters are available to input.
5. The content related to Ser is shown in the table 1.
6. Press OK key to setup the changed content.
7. Press ESC key to cancel the changed content.



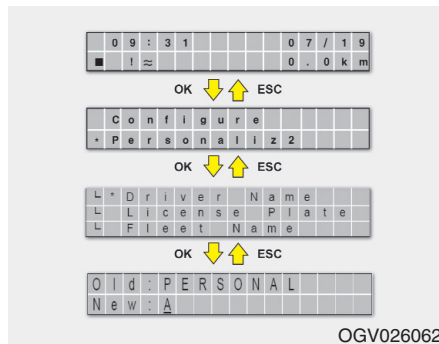

#### Company name setup

1. Press OK key for more than 1 sec.
2. Select Personalize menu.
3. Select Fleet Name.
  - 1) Using [▶] key, you can select the position to change.
  - 2) Using [▲], [▼] key, you can change fleet name.
  - 3) Press [Shift+▶] to move the position of character backward.
4. Total twelve characters are available to input.
5. Press OK key to setup the changed content.
6. Press ESC key to cancel the changed content.

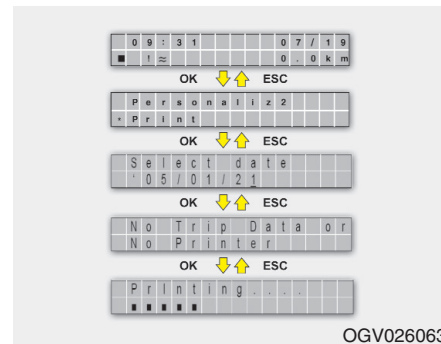

#### Printer setup

1. Press OK key for more than 1 sec.
2. Select Print menu.
3. Using [▶], [▲][▼], select the date to print.
4. In case there is no driving information or the printer is not set, the next message is displayed.
5. If the normal print is completed, it will return to the previous menu after the next message is displayed.

#### Printer output type

- The output type is available for portable printer. The printer is for two people (48mm, 384dots) and output material is mainly printed with report and graph.
- There are two axes. Time axis indicates 1 dot per 1 minute and speed axis indicates 2 dots per 1 km/h. But the speed over 150 km/h indicates in 150 km/h.

#### How to download the ADR data through the USB terminal

1. Insert the USB memory to the USB terminal in the front of DTG.
  2. Push the [SHIFT] key and [▲] key simultaneously.
  3. Select the ADR data by [▲], [▼] key.
  4. Push the OK key.
  5. Check the completion message after downloading.
  6. Remove the USB memory from the DTG.
- × Visit web site in case of losing CD-ROM supplied by manufacturer.
- Download web address
    - User manual: [http://www.hke-car.com/dtg/dtg\\_manual.pdf](http://www.hke-car.com/dtg/dtg_manual.pdf)
    - DTC analysis program: [http://www.hke-car.com/dtg/dtg\\_sw.zip](http://www.hke-car.com/dtg/dtg_sw.zip)

## MULTI-DISPLAY SYSTEM (IF EQUIPPED)



This is the device that displays various gages, warning lamps, trouble diagnosis and driving information etc. through multi-display on the gauge panel after CPU receives signals from various sensors and switches.

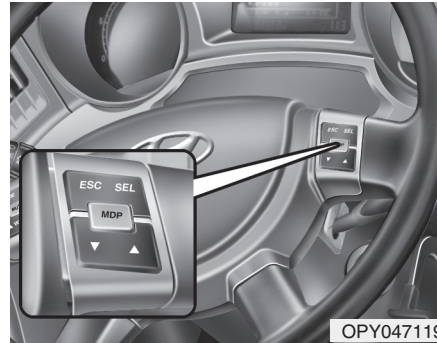

### How to operate

It is operated by the remote control switch on the steering wheel.

- ▲ / ▼ : Up, down button
- SEL : Selection button
- ESC : Cancel button

※ Main menu screen is displayed if "SEL" button is selected in the initial screen.

### Display Screen

If the ignition key is turned "ON"(not starting), the initial screen(Air gauge) is displayed. If the engine starts, the screen will be changed to the initial screen(Air gauge) after checking if oil gauge, voltage gauge, air gauge are good or not.

### Main menu function

1. Warning light display
2. Clock display
3. Total distance and distance of individual trips display

**Multi-display screen menu**

Items	Menu	Descriptions
Gauge	Oil gauge Voltage gauge Air gauge	Indicates the condition of gauge by bar type
Driving information	Driving time Operation time Average speed	Indicates driving time Indicates engine operation time Indicates vehicle average speed
Setup alarm	Alarm time Vehicle speed/ operation time warning Idle time warning	Indicates clock alarm Indicates warning when exceeding vehicle speed, driving time pre-setted  Indicates warning when exceeding idle time pre-setted
Setup	LCD illumination	Indicates control of LCD illumination
Troubleshooting	Engine/ABS Retarder	Indicates message that engine or ABS system is defective Indicates message that retarder is defective
Maintenance interval setup	Maintenance interval setup	Indicates maintenance interval pre-setted about periodical replacement parts(engine oil, oil filter, air cleaner, fuel filter, APU cartridge, TM oil, axle oil, power steering oil etc.)
Initial screen setup	Gauge	Indicates function to change gauge among gauges on the initial screen
Engine sensor information		Indicates condition of engine sensors(Accelerator pedal opening, clutch, brake, cruise, Set/Inc, Rec/Dec, engine brake 1st/2nd/3rd ON/OFF)

## HEATER AND AIR CONDITIONER

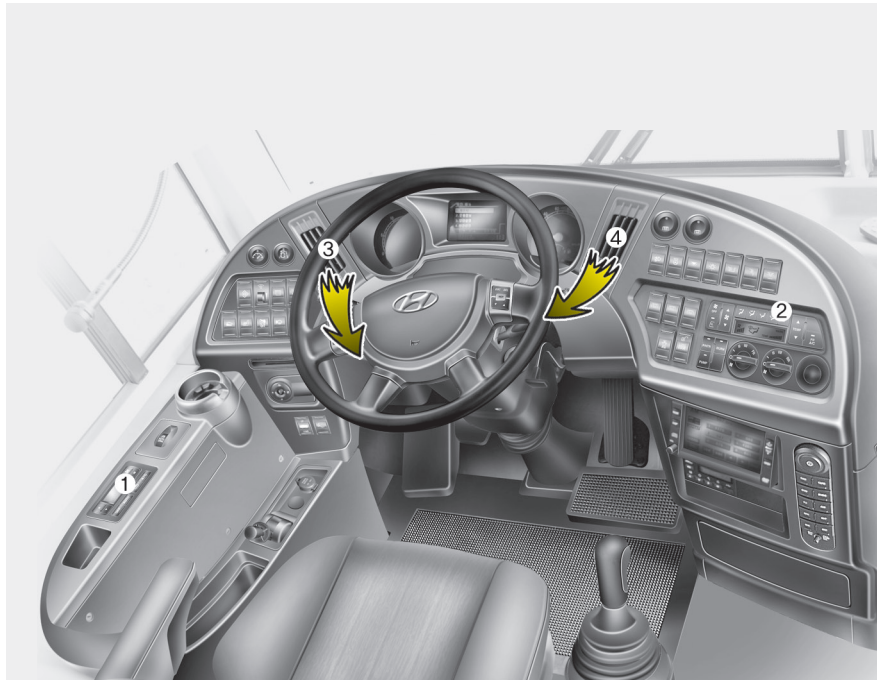

- 1. Air conditioner controller (Passenger)
- 2. Front heater controller (Driver)
- 3. Driver's air conditioner vent (Left)
- 4. Driver's air conditioner vent (Right)

OPY047200

**AIR CONDITIONER SYSTEM (FOR PASSENGER)****Control panel**

- 1,2 : Temperature set-up
- 3,4 : Air amount control
- 5 : Air conditioning OFF
- 6 : Automatic switch
- 7 : Outdoor/Indoor air selection
- 8 : Air conditioning switch
- 9 : Display
- 10 : Emergency switch

**How to operate switch**

When the ignition key is in the "ON", the pre-setted temperature and outdoor temperature will be displayed on the screen (9).

AMB: Current outdoor air temperature

**Outdoor/Indoor air selection function (7)**

When the switch (7) is selected, outdoor air entry damper will open and air in the outdoor will be introduced. The light of outdoor/indoor air selection is lit on the screen (9).

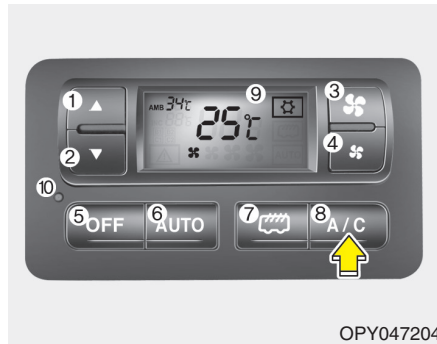

OPY047204

### Air conditioner switch (8)

While the engine is operating, if the air conditioner switch (8) is selected, air conditioner lamp is illuminated on the display and the air conditioner will be operated.

While the air conditioner is operating, blower fan alone will be operated if the switch (8) is selected again. Manual operation is operated regardless of the set temperature.

The clutch of air conditioner system will be disengaged in case the temperature inside vehicle is below 17°C while air conditioner is on.

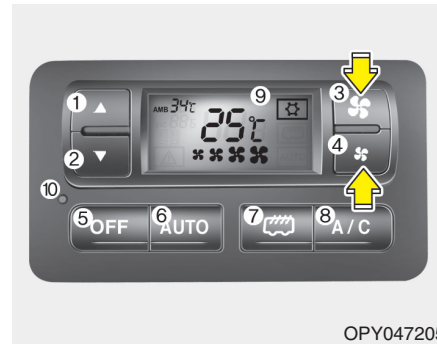

OPY047205

### Fan speed control switch (3,4)

This switch (3,4) is used to turn on the blower fan speed and to control the volume of air delivered from the system manually. Air volume can be operated from 1<sup>st</sup> to 4<sup>th</sup> step manually.

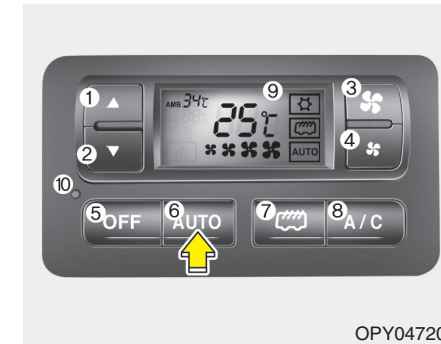

OPY047206

### Automatic operation (6)

The switch (6) is used to operate the air conditioner automatically and is operated by the set temperature. The set temperature ranges from 17°C to 30°C.

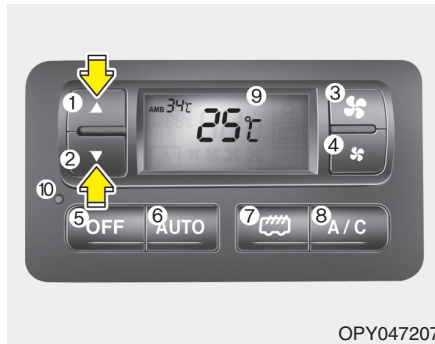

### Setting temperature (1,2)

The set temperature (1,2) can be operated by setting temperature while the air conditioner is operating. The set temperature ranges from 17°C to 30°C at the rate of 1°C whenever the switch (1,2) is selected. The buzzer will sound whenever being selected and beep will sound in succession 5 times at 17°C or 30°C.

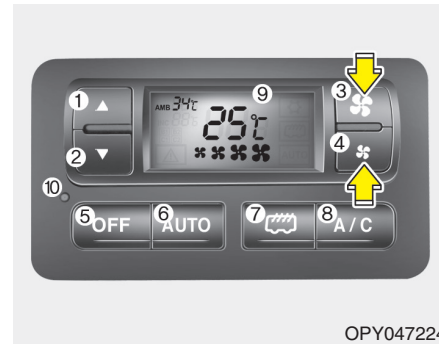

### Fan speed control switch (3,4)

The switch (3,4) is used to circulate air inside vehicle by blower motor alone without operating air conditioner. The air volume ranges from 1<sup>st</sup> to 4<sup>th</sup> step.

The blower motor alone is operated by selecting the switch (3,4) under system stand-by condition. While the air conditioner is operating, if the switch (8) is selected again, the blower motor alone is operated.

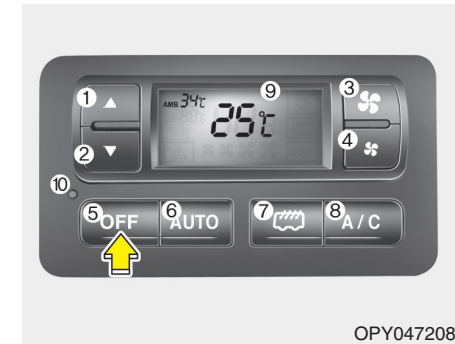

### OFF switch (5)

The switch (5) is used to stop the air conditioner and the display (9) is changed into stand-by mode. (In the ignition key "ON" position)

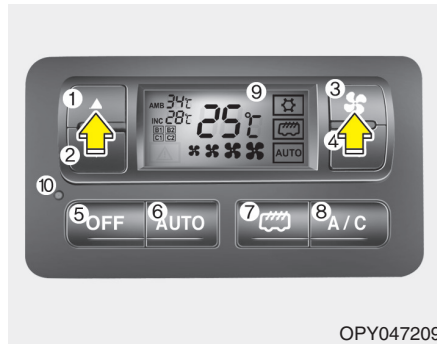

OPY047209

### Operation display function

It is possible to check such conditions as the temperature inside vehicle, condenser motor speed and refrigerant pressure control from a display. Current operating condition will be displayed when the buttons(1 and 3) are selected simultaneously. (Deletion when selecting again)

#### Display condition

INC : Current temperature inside vehicle  
C1 : Condenser motor 1st step  
C2 : Condenser motor 2nd step  
S1 : Refrigerant pressure 1st control  
S2 : Refrigerant pressure 2nd control



OPY047210

### Refrigerant charge function

The buttons (2 and 8) are used for "Charge" operation when it is necessary to operate the air conditioner while refrigerant is being charged under such a condition as it is impossible to operate air conditioner below 17°C temperature inside vehicle like winter season.

"CHg" is shown on the display (9) while the refrigerant is being charged.

Selecting buttons again is changed to previous operation status. At this time, there is dealt with error when abnormal high or low pressure, power or communication error occur.



OPY047211

### Emergency operation function

This is the function to operate in case the normal operation is impossible due to CPU malfunction while operating. If the switch(10) is selected with a sharp thing, the fan speed is forced to be controlled by 4th speed and the lamp is changed into "RED" color.

There is no condition indication in display. If the switch (10) is selected again, emergency operation is released and the indication will be the condition of standby.

Be sure to release the switch (10) by selecting it again after use.



## FRONT HEATER SYSTEM (FOR DRIVER)



- 1. Air intake control
- 2. Fan OFF
- 3. Fan speed control

- 4. Air flow control
- 5. Temperature control button
- 6. Warn lamp

OPY047212L

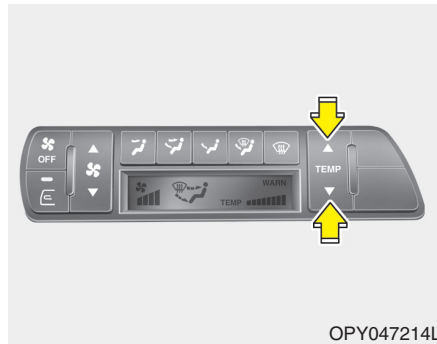

### Temperature control (5)

The temperature can be obtained by using the button (5)

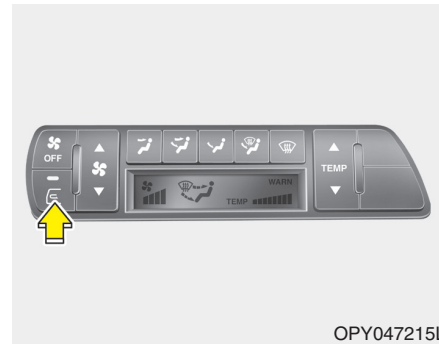

### Air intake control (1)

This allows you to select fresh outside air or to circulate inside air.

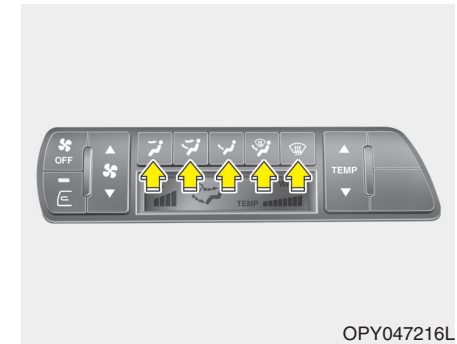

### Air flow control (4)

This is used to direct the flow of air. Air can be directed to the floor, dashboard outlets, windshield. Five symbols are used to represent Face, Bi-level, Floor, Floor-defrost, Defrost air position.

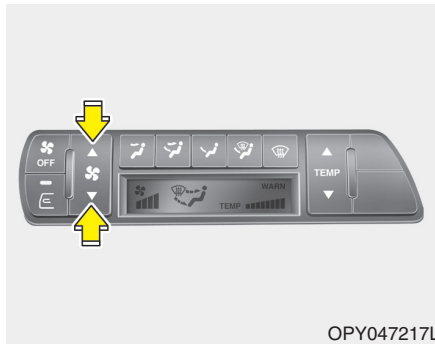

OPY047217L

### Fan speed control (3)

This is used to turn the fan on and select the fan speed.

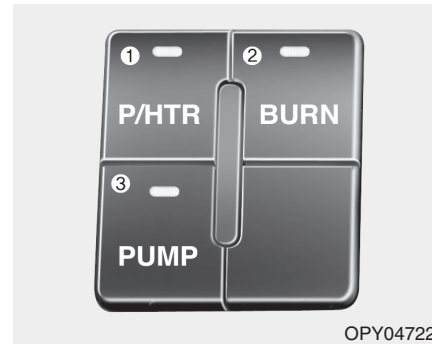

OPY047220

### Pre-heater button (1)

If this button (1) is selected, the button (1) turns on, the pump button (3) lamp is illuminated and water pump is operated. The burner is operated in 20~30 sec. and if burn signal is sent to burner, the burn (2) lamp turns on. The pre-heater lamp always turns on regardless of the operation of burner and if the burner is not operated, burn (2) lamp will turn off.

- If the button (1) is selected again, pre-heater lamp and water pump lamp turn off. The pre-heater drive motor and water pump motor will turn off about 3 minutes later.

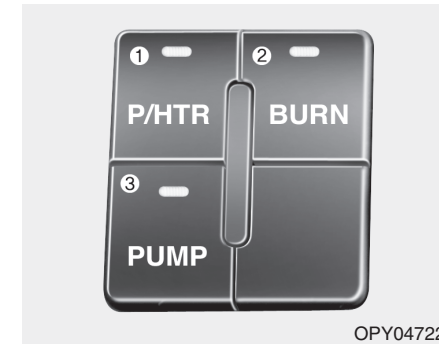

OPY047220

### Pump button (3)

- If this button (3) is selected, the water pump is operated and the lamp turns on. If press again, the lamp and the water pump will be off about 3 minutes later.

If the water pump is not operated, the lamp will not turn on.

- Although the button (3) is selected, the pre-heater lamp and burn lamp are not turned on.

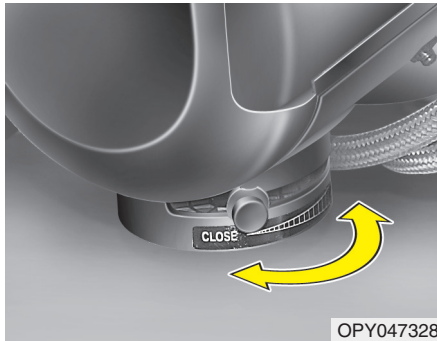

OPY047328

### ***Preheater exhaust gas adjustment***

#### **When black smoke is exhausted**

- \* Cause : Insufficient air in intake system
- \* Adjustment : If you loosen the fixed bolts and turn the control lever to "OPEN", it can prevent black smoke by increasing air quantity.

Tighten the bolts after properly controlling intake air quantity.

#### **When white smoke is exhausted**

- \* Cause : Excessive air in intake system
- \* Adjustment : If you loosen the fixed bolts and turn the control lever to "CLOSE", it can prevent black smoke by decreasing air quantity.

Tighten the bolts after properly controlling intake air quantity.

#### **Warning (6) lamp**

If the air conditioner system for the driver is abnormal or is icing, the warn lamp(6) turns on.

## HEATER



### For passenger

- 1. Front
- 2. Center
- 3. Rear

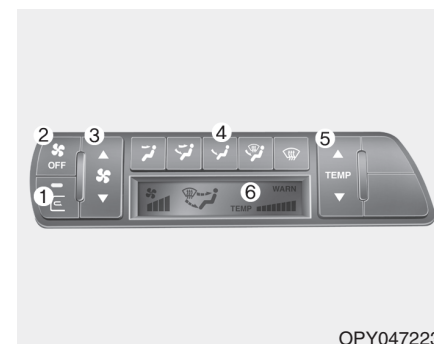

### For driver

Use button (3) to control air amount and button (5) to control temperature.

## AUDIO SYSTEM

### RADIO & TONE / VOLUME CONTROL, EQ PART



1. Power button and volume controller
2. 3. Automatic station selection button
4. Driver's seat speaker switch
5. LCD screen
6. Radio band selection button (AM/FM)
7. Automatic station selection and memorization button
8. Preset button
9. A. MODE
10. Acoustic EQ

PY H0475

**1. Power Button (POWER ON)**

Press this button when the ignition switch of the automobile is set to ACC (1st notch) or ON (2nd notch) to turn on the power and the audio system. When the power and the audio system are on, the volume will increase when you turn the volume control clockwise and reduce, counterclockwise. Press this button once again while using the audio system to turn off the power.

**2. Automatic Station Selection Button (SEEK)**

Press and hold  $\wedge$  button for at least 1 second to automatically increase frequency and  $\vee$  button, to decrease frequency and select and play the next available station. If the received station is the station memorized in the preset buttons then the screen will display the memorized station.

**3. Manual Station Selection Button (TUNE)**

Press  $\wedge$  button for less than 1 second to increase frequency by 1 step and  $\vee$  button, to decrease frequency by 1 step.

**4. Driver's Seat Speaker Switch**

When you press this button once, the LCD will display (D-SP) and the sound will only come through the driver side speakers. When you press this button again, the LCD will display (P-SP) and the sound will come through the all speakers excluding the driver side speakers.

**5. LCD Screen**

A variety of information will be displayed on the screen while listening to the radio including the radio bands (FM1/FM2/AM), frequency of each station, the number of preset station and "ST" for FM stereo broadcasting. It also displays speaker output status each time you press AUX button.

**6. Radio Band Selection Button (AM/FM)**

Press this button to listen to either FM or AM. Each time you press this button the band will switch from FM1→FM2→AM and back to FM1.

**7. Automatic Station Selection and Memorization Button (BSM: Best Station Memory)**

Press this button once to automatically select stations starting from the current station and memorize them into the preset buttons (1~6); better received stations first.

**8. Preset Button (1~6)**

Press and hold this button for less than 2 seconds to listen to the stations memorized to each button. If you are listening to another station than the one memorized in the current preset button after search through stations using TUNE or SEEK and if you wish to memorize the current station to the preset button, press the corresponding preset button for more than 2 seconds then the station will be memorized to the button.

### **9. A. MODE (BAS/TRE/BAL/FAD)**

Press and hold this button for more than 1 second to enter A.MODE. Each time you press the button, the mode will switch from BAS→TRE→FAD→BAL and back to BAS and you will be able to adjust each tone by turning the controller to the right or left.

### **10. AQUSTIC EQ**

Press and hold this button for less than 1 second to change equalizer settings. Every time you press the button, the equalizer setting will switch from CLASSIC→JAZZ→ROCK→DEFEAT. A. MODE will not be active in MIC. MODE.



## CASSETTE TAPE PART

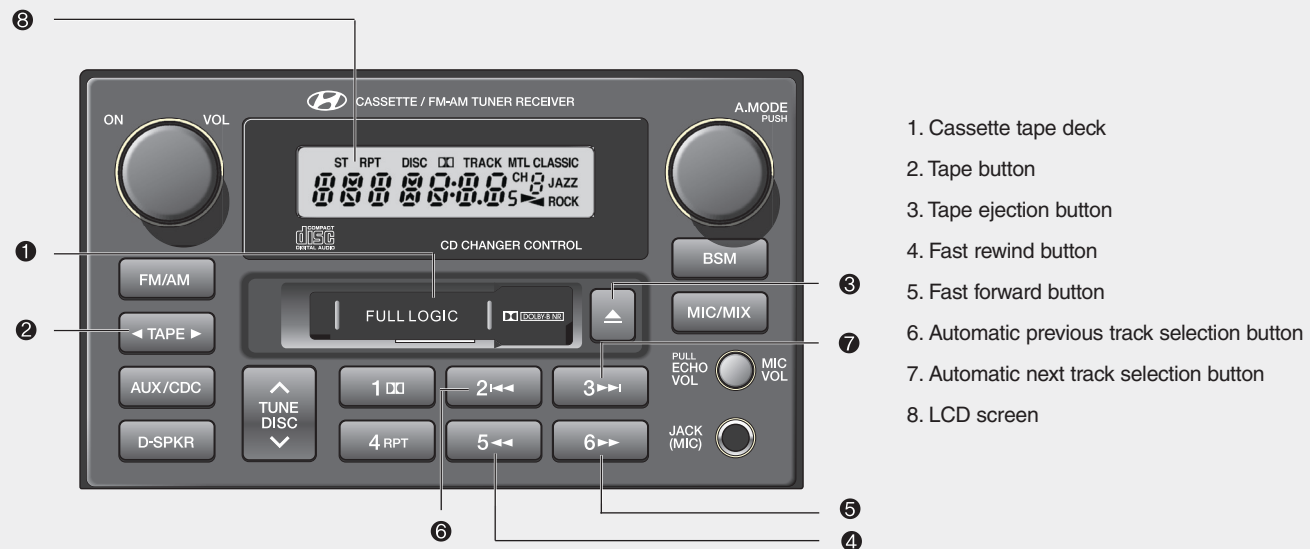

PY H0475

### 1. Cassette Tape Deck (Insert Tape)

When you insert the tape, make sure the side where you can see the tape faces right. If the ignition switch of the automobile is set to ACC (1st notch) or ON (2nd notch), the tape will be automatically played when you insert the tape even if the power of the audio system is off.

### 2. Tape Button

When you press this button while in another mode, the system will play the tape. When you press this button while the tape is being played, it will start to play the other side of the tape.

### 3. Tape Ejection Button

Press this button while the tape is being played to eject the tape. This will eject the tape even when the ignition switch of the automobile is set to OFF.

### 4. Fast Rewind Button (Rewind)

Press 5 ◀◀ button while playing the tape to rewind the tape to the beginning and press it again while rewinding to play from the current position.

### 5. Fast Forward Button (Fast Forward)

Press 6 ▶▶ button while playing the tape to wind the tape to the end and press it again while winding to play from the current position.

### 6. Automatic Previous Track Selection Button

Press 2 ◀◀ button to rewind the tape to the beginning of the song you are listening to. While rewinding the tape, the screen will flicker "REW." Press the button again while rewinding the tape to play from the current position.

### 7. Automatic Next Track Selection Button (AMS-FF)

Press 3 ▶▶ button to wind the tape to the beginning of the song next to the song you are listening to. While winding the tape, the screen will flicker "FF." Press the button again while winding the tape to play from the current position.

### 8. LCD Screen (LCD)

Various status of cassette tape will be displayed on the screen while listening to the tape such as "PLAY" while playing the tape, the direction of play "◀ or ▶" and so forth.

## CD CHANGER (CDC) PART

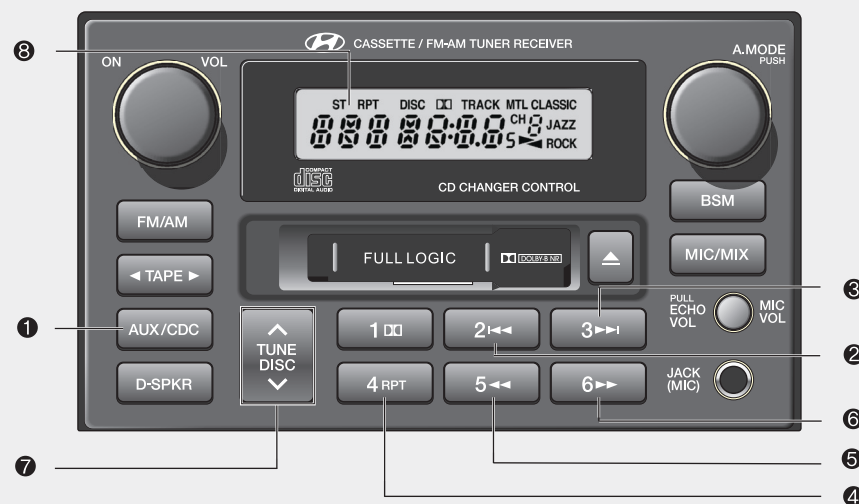

1. CDC mode button
2. TRACK DOWN
3. TRACK UP
4. Section repeat button
5. Fast rewind button
6. Fast forward button
7. DISC UP/DOWN
8. LCD screen

PY H0475

### 1. CDC Mode Button

Press this button while in another mode to turn to CDC mode (if the CD changer is connected).

#### \* NOTICE

- When you press this button once again in CDC mode, the system will turn to AUX MODE.

### 2. TRACK DOWN

Press 2 ◀◀ button to move to the previous track.

### 3. TRACK UP

Press 3 ▶▶ button to move to the next track.

### 4. Track Repeat Button

Press 4 RPT button to repeat the track.

### 5. Fast Rewind Button

Press 6 ▶▶ button once or hold the button to move back quickly. The display will not change but indicate the track number when you pass each track.

### 6. Fast Forward Button

Press 6 ▶▶ button once or hold the button to move forward quickly. The display will not change but indicate the track number when you pass each track.

### 7. DISC UP/DOWN

Press ^ to move up the disk and v to move down.

### 8. LCD Screen (LCD)

Various status information of the CD will be displayed while using CDC including "PLAY" while playing CD, the DISC/ TRACK information of the CD.